

ART. NR.: **GB.5081577**

ETN: **GEL 508 0 15 011**

DIN: **50815**

GT9B-4

Specifications

Model NO .	GT9B-4 DIN:50815 ETN:GEL508015011	
Same Dimensions As YUASA Model	YT9B-BS	
Nominal Voltage	12V	
Rated Capacity (10 hours rate)	8.0AH	
Dimension	Length	150 mm (5.91 inches)
	Width	70 mm(2.72 inches)
	Height	102mm (4.13 inches)
	Total Height	102mm (4.13 inches)
Approx. Wight	Approx. 2.96kg (6.52Lbs)	
Charge Current (A)	0.8A	



Characteristics

Capacity 25°C(77°F)	10hours rate (0.8 A to 10.5V)	8.0 Ah
	5hours rate (1.6 A to 10.2V)	6.8Ah
	1C (8 A to 9.6V)	3.6Ah
	3C (24A to 9.6V)	2.9Ah
Cold Cranking Amperes(-18°C EN Standard)		110 A
Internal Resistance (at 1KHz)		Approx.7.5m Ω
Operating Temperature Range	Charge	0°C (32°F) to 40°C (104°F)
	Discharge	-15°C (5°F) to 50°C (122°F)
	Storage	-15°C (5°F) to 40°C (104°F)
Life Expectancy (Cycle Use)	100% depth of discharge 200 cycles	
	80% depth of discharge 225 cycles	
	50% depth of discharge 500 cycles	
Charge Retention (shelf life) at 20°C (68°F)	1 month	92%
	3 month	90%
	6 month	80%
Standby Use	3~5 years	
Case Material	ABS	

Dimensions

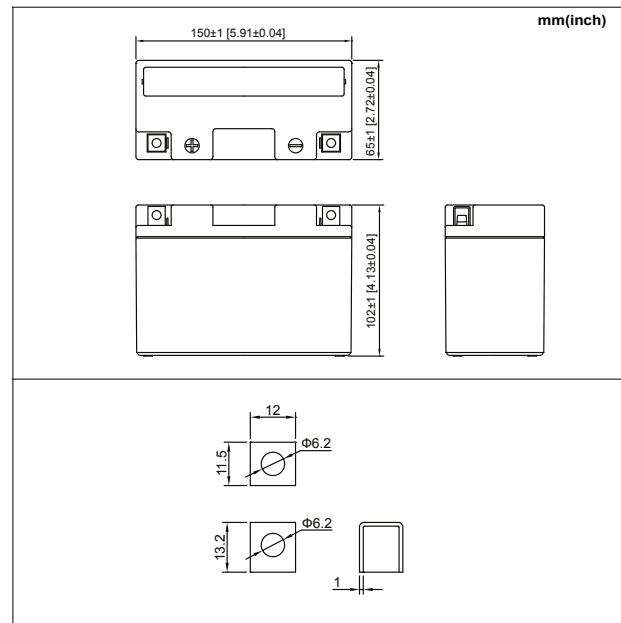

(V)
FOR 12V
BATTERY

Discharge Time VS. Discharge Current(25 °C)

